

AmBuck™ Insulated Block-Out System

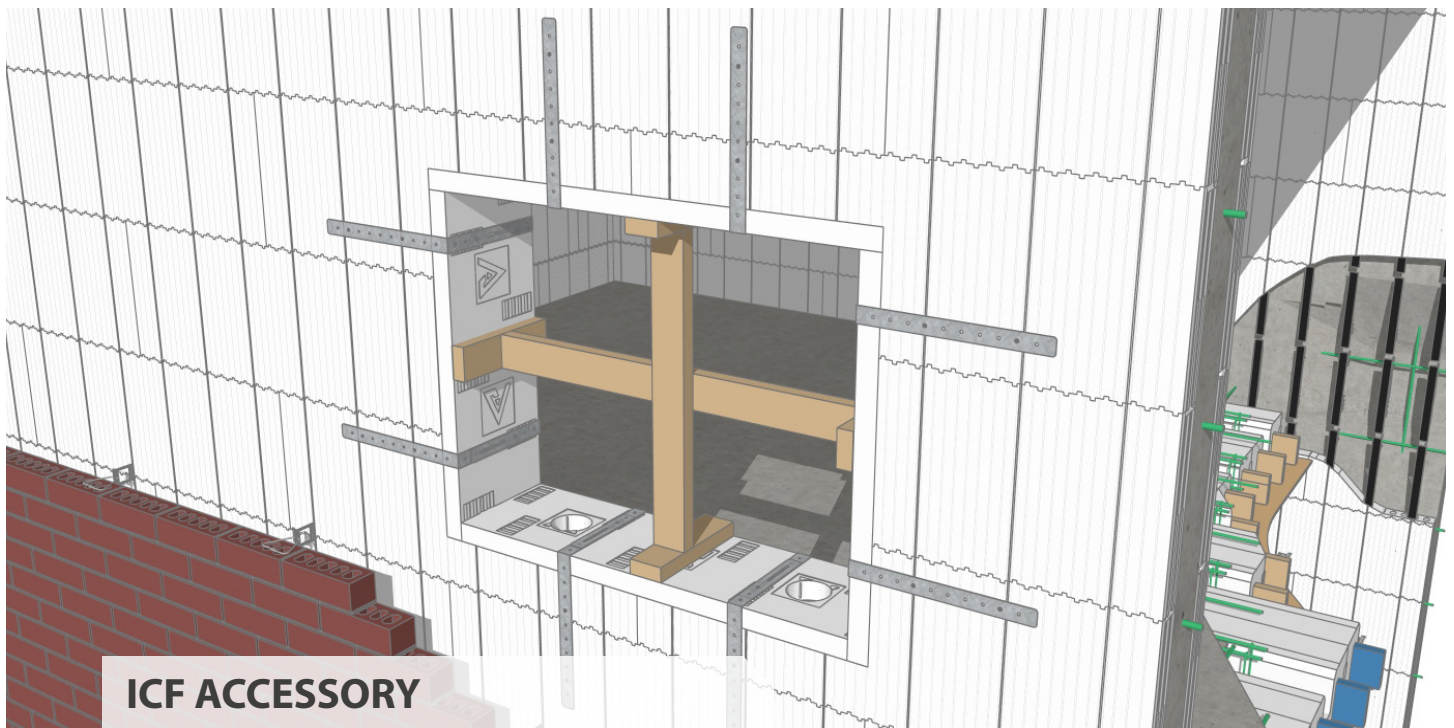

ICF ACCESSORY

AmBuck™ Insulated Block-Out System for windows and doors is a stay in place buck formwork manufactured using Type II/ Type 2 closed cell, Expanded Polystyrene (EPS) panels for ICF construction walls. AmBuck™ Insulated Block-Out System eliminates the need for wood and vinyl block-outs, while being a cost effective and energy efficient solution. It is an adequate approach to creating block-outs in ICF walls and can enhance any ICF project. AmBuck™ Insulated Block-Out System ensures exceptional quality, and reduces construction time.

AmBuck™ Insulated Block-Out System prevents warping, checking, cupping, bowing, rotting, and splitting from occurring, that is seen in most conventional wood-based block-out systems.

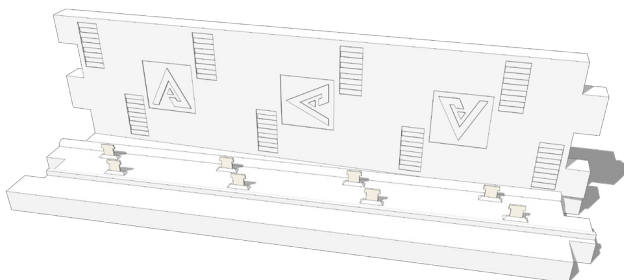

Alleguard Advantage

- Compatible with 6" (152mm) and 8" (203mm) core Amvic™ R22 and R30 ICF systems.
- Stable long term thermal resistance, greater than typical wood or vinyl bucks.
- Long-life expectancy equal to that of the ICF system into which it being installed to.
- Integrated Insulation, preventing thermal bridging and gaps.
- Fast and easy assembly.
- Lightweight, allowing ease of installation.
- High vapor permeance allowing wall assemblies to dry over time.
- Does not promote growth of mold and mildew.
- Each panel is easy to handle due to the low weight.

Physical Properties Table

	Standard	Units	AmBuck™ Insulated Block-Out System
Specification for Rigid Polystyrene Insulation	ASTM C578		Type II
	CAN/ULC-S701.1		Type 2
Thermal Resistance ¹	ASTM C518	F.ft ² .hr/Btu	4.2
	@ 75°F (24°C)	(m ² K/W)	(0.74)
Compressive Strength	ASTM D1621	psi	20
	@ 10% Strain	(kPa)	(138)
Water Absorption (Max.)	ASTM D2842	%	3.0
Water Vapor Permeance (Max.) ¹	ASTM E96	US perms	3.50
		(ng/Pa.s.m ²)	(200)
Flexural Strength (Min.)	ASTM C203	psi	35
		(kPa)	(242)
Dimensional Stability (Max.)	ASTM D2126	%	1.5
Limiting Oxygen Index (Min.)	ASTM D2863	%	24
Density	ASTM D1622	lb/ft ³	1.50
		(kg/m ³)	(24)
Surface Burning Characteristics	ASTM E84/UL-723 ²		
	Flame Spread Index (FSI)		≤25
	Smoke Developed Index (SDI)		≤450
	CAN/ULC-S102.2 ²		
Flame Spread Index (FSI)		≤210	
Smoke Developed Index (SDI)		≥500	
¹ Measurement per 1" (25mm) of thickness			
² For thicknesses up to 4" or 100mm			

AmBuck™ Insulated Block-Out System are fastened and secured in place using Buck Braces that shall be installed no less than 24" (610mm) apart on 6" (152mm) core ICF block and 18" (457mm) apart on 8" (203mm) core ICF block. This minimum distance between braces allows for there to be adequate window and door opening bracing. It is recommended that additional bracing be installed, where needed to support the anticipated weight of the concrete within the ICF assembly.

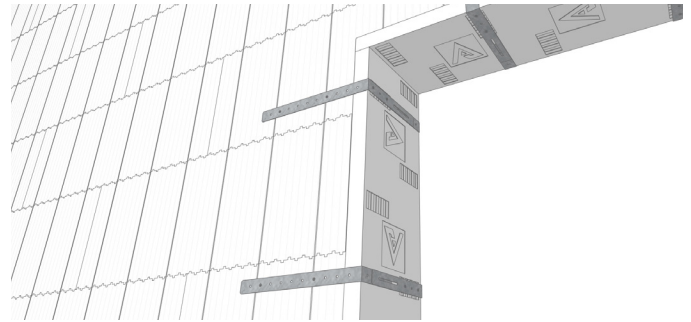

AmBuck™ Insulated Block-Out System is equipped with eight (8) attachment anchors that mechanically connect to concrete. The system is equipped with integrated webs that support the swift installation of doors and windows.

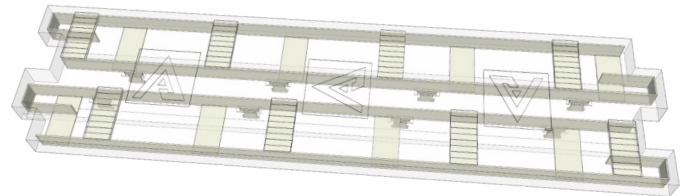

Availability

AmBuck™ Insulated Block-Out System allows for easy assembly and can accommodate 6" (152mm) and 8" (203mm) core Amvic™ R22 and R30 ICF systems, in addition to most other 6" (152mm) and 8" (203mm) core ICF systems. AmBuck™ Insulated Block-Out System panels are 2" (51mm) thick, with a nominal length of 48" (1.22m).

Applications

- Door Frames
- Window Frames

