

Amgard Prefinished Insulated Panel



SKIRTING TRANSITION PANEL

Amgard is an insulated, prefinished panel designed to be installed on the exterior perimeter of a building at or near grade. The combination of closed cell, high density Expanded Polystyrene (EPS) foam with high strength fiber reinforced cement facing makes for a high quality and durable panel.

The 5/16" (8mm) thick facing provides the panels with superb impact resistance while keeping the panels lightweight (~25lb (11kg)). The wall panels are installed using a hidden (galvanized steel) clip system. Amgard panels can be used in both new and retrofit applications for commercial, residential, industrial and institutional applications.

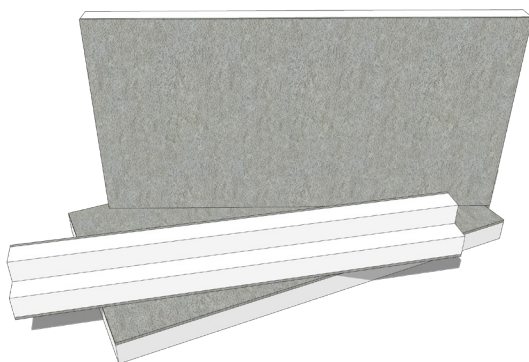

Alleguard Advantage

- Provides additional thermal and accidental impact resistance for the foundation wall at grade.
- Square edges on all four sides allow the panels to be installed in any orientation.
- EPS foam core provides stable long term thermal resistance with increased thermal resistance in lower temperatures.
- EPS foam core does not off-gas and does not contain HFCs, CFCs or HCFCs.
- Can be installed in almost any weather condition.
- Can be used over concrete, block or masonry foundation walls.
- NFPA 286 compliant for interior below grade applications.

Physical Properties Table

Specification for Rigid Polystyrene Insulation	ASTM C578 CAN/ULC-S701	Type II Type 2
Thermal Resistance ¹	ASTM C518 @ 75°F (24°C)	4.0 F.ft ² .hr/Btu (0.70 m ² K/W)
Foam Compressive Strength	ASTM D1621	16 psi (110kPa)
Water Absorption (Max.)	ASTM D2842	3.00%
Water Vapor Permeance (Max.) ¹	ASTM E96	3.50 US perm (200 ng/Pa.s.m ²)
Flexural Strength (Min.)	ASTM C203	35 psi (242 kPa)
Dimensional Stability (Max.)	ASTM D2126	1.5%
Limiting Oxygen Index	ASTM D2863	>24%
Foam Density	ASTM D1622	1.35 lb/ft ³ (22 kg/m ³)
Surface Burning Characteristics	ASTM E84 ²	
	Flame Spread Index	≤25
	Smoke Developed Index	≤450
	CAN/ULC-S102 ³	
	Flame Spread Index	≤210
	Smoke Developed Index	≥500

¹ Measurement per 1" (25mm) of thickness

² For thicknesses up to 4"

³ For thicknesses up to 100mm

Availability

Amgard panels are 2x4' (610x1219mm) and are available in a wide range of thicknesses ranging from 2" to 6" (51-152mm). Panels come in standard concrete gray color but can be special ordered to virtually any color or texture.

Applications

- Transition panels at grade
- Short walls
- Below grade interior walls
- Roof parapet walls

Warranty

Alleguard supports building owners, designers and contractors by offering a 20-year, limited thermal warranty on Amgard product line. This warranty is available to the building owner at the time the building is completed and is transferable to any subsequent owner during the 20-year period.

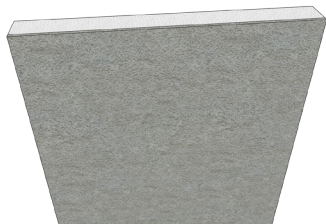

Straight Panel

Straight, flat panel with square edges can be installed either vertical or horizontal orientation. Can be cut to accommodate any size.

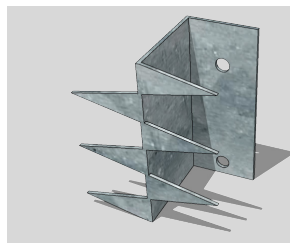

Double Sided Clip

The double sided clip is 3" (76mm) tall and is designed to be used between panels to secure them together and to the wall.

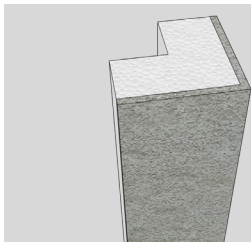

Corner Panel

The corner panel is 4' (1219mm) tall and projects 5" (127mm) to each side. It can be cut in half to accommodate horizontal installation.

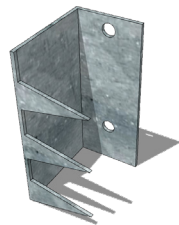

Single Sided Clip

The single sided clip is 3" (76mm) tall, designed to be used as either a starter or an ending clip to secure panels to the wall.



Termination Panel

The termination panel measures 5" (127mm) long and has two prefinished faces to be used where an additional finished face is required.



Base Clip

The base clip is 12" (305mm) long and designed to be installed at the bottom of the panels to provide support and ease of installation.