

Rigid Insulation with Drainage

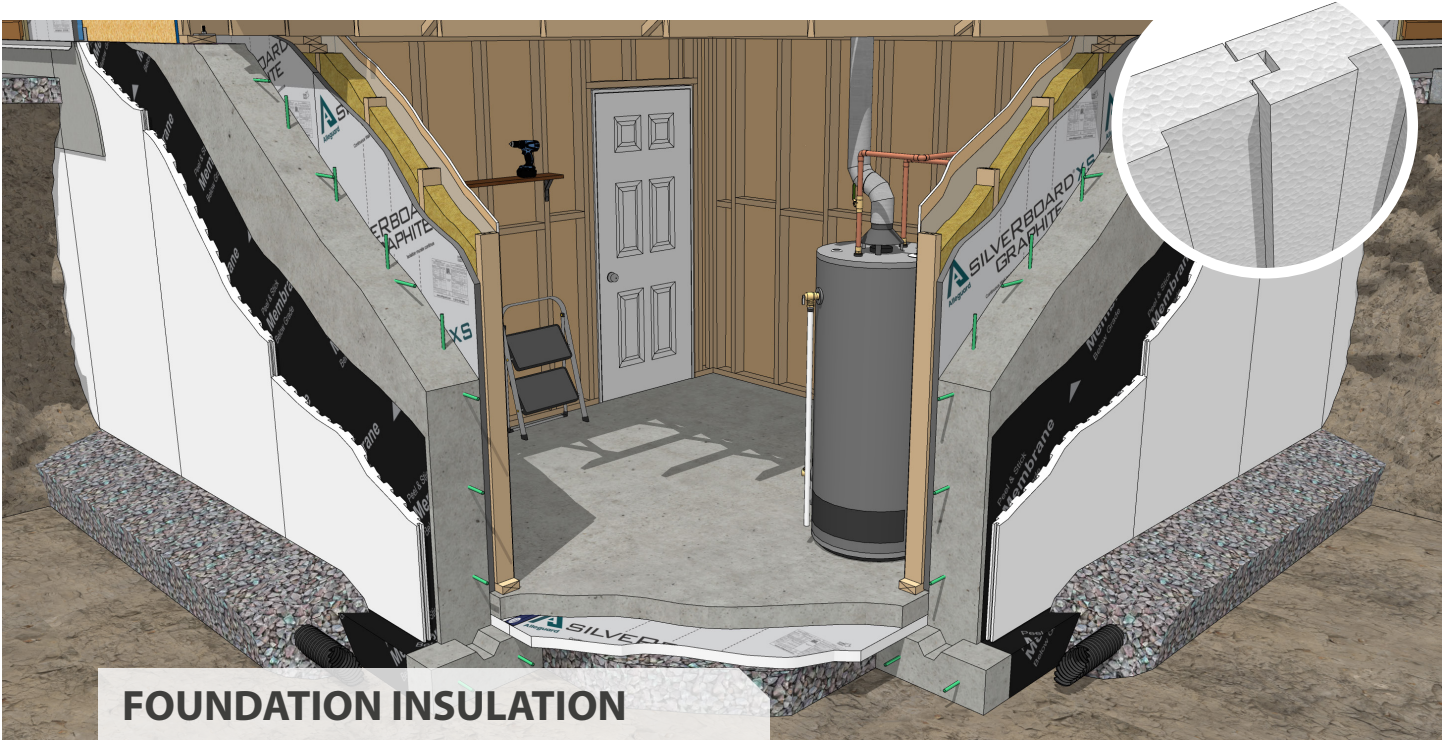

FOUNDATION INSULATION

Amdrain is a non-structural, rigid insulation board made from Type II, closed cell, Expanded Polystyrene (EPS) with one flat side and one with vertical grooves providing both drainage and insulation.

It is commonly used as exterior foundation insulation but can be used as a supplementary component in many types of below grade assemblies.

The interior surface of the board is vertically grooved to provide an additional drainage plane relieving any hydrostatic pressure that may develop; the moisture is redirected down to the drainage tile.

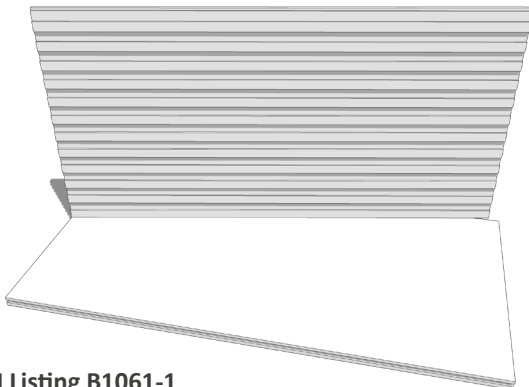

QAI Listing B1061-1

Alleguard Advantage

- Tongue and groove edge profile eliminate the need for taping of the joints.
- Provides additional protection to the waterproofing during the backfill stage.
- Stable long term thermal resistance.
- Increased thermal resistance in lower temperatures.
- High vapor permeance allowing wall assemblies to dry over time.
- Does not promote growth of mold and mildew.
- No off-gassing and does not contain HFCs, CFCs or HCFCs.
- Each panel is easy to handle due to the low weight and can be easily cut.

Physical Properties Table

Specification for Rigid Polystyrene Insulation	ASTM C578	Type II
	CAN/ULC-S701	Type 2
Thermal Resistance ¹	ASTM C518 @ 75°F (24°C)	4.2 F.ft ² .hr/Btu (0.74 m ² K/W)
Compressive Strength	ASTM D1621	20 psi (152kPa)
Water Absorption (Max.)	ASTM D2842	3.0%
Water Vapor Permeance (Max.) ¹	ASTM E96	3.50 US perm (200 ng/Pa.s.m ²)
Flexural Strength (Min.)	ASTM C203	35 psi (242 kPa)
Dimensional Stability (Max.)	ASTM D2126	1.5%
Limiting Oxygen Index	ASTM D2863	>24%
Foam Density	ASTM D1622	1.5 lb/ft ³ (24 kg/m ³)
Surface Burning Characteristics	ASTM E84 ²	
	Flame Spread Index	≤25
	Smoke Developed Index	≤450
	CAN/ULC-S102 ³	
	Flame Spread Index	≤210
	Smoke Developed Index	≥500
	¹ Measurement per 1" (25mm) of thickness	
	² For thicknesses up to 4"	
	³ For thicknesses up to 100mm	

Availability

Amdrain is available in various thicknesses ranging from 1.5" (3.8mm) to 6" (152mm). Boards come in 4x8' (1.2x2.4m) with custom sizes available for special order.

Applications

- Exterior of foundation walls
- Frost walls
- Interior of foundation walls with water ingress issues

Warranty

Alleguard supports building owners, designers and contractors by offering a 20-year, limited thermal warranty on Amdrain product line. This warranty is available to the building owner at the time the building is completed and is transferable to any subsequent owner during the 20-year period.

